

FINAL

Scanned and emailed to Escape Trailers

## Escape Trailer Industries Ltd.

43851 Industrial Way, Building B, Chilliwack, BC, V2R 4L2

Telephone 604 703 1650 / Fax 604 703 1651

GST# 807407150 / PST# 1001-4278

Sold To HANSON, Charles (Chuck) and/or

(Legal Name):

Address:

email address: chuckwhanson@yahoo.com

Phone Number 612-269-7689

Order Date: 8-Jun-16

Completion Date: 8-Mar-17

QAI Certification

QAI Nameplate

Trailer VIN:

# Build Sheet

Floor Plan: 2017, 19' Escape Travel Trailer Base Price

Options: **Please Note: Your Deadline for Confirmation is DECEMBER 8, 2016**

1DEC16 SM	<b>DELETE COOKTOP &amp; RANGEHOOD</b>
1DEC16 SM	6 cuft Fridge
1DEC16 SM	External Fridge Fan
1DEC16 SM	Microwave ( <b>Built into Cabinet</b> )
1DEC16 SM	2 - Way Hot Water Tank
1DEC16 SM	Foot Flush Toilet
1DEC16 SM	Winterizing T-Valve
1DEC16 SM	<b>4- 120V Interior Outlet (\$75.00 each) 1) Across from Standard Outlet #5 2) D/S O/H Beside Fridge 3) P/S Bed O/H Near Rear 4) Centered above kitchen drawers</b>
1DEC16 SM	Dual 6V Batteries (232 amp hrs)
1DEC16 SM	Inverter 1500W Includes <b>Transfer Switch and all outlets</b> *This Option will require Dual 6V Batteries
1DEC16 SM	Surge Protector
1DEC16 SM	Removable Power Cord
1DEC16 SM	<b>1- Additional Exterior LED Light (\$75/each) Front Above Storage Box</b>
1DEC16 SM	<b>4- LED Captains Reading Lamps (\$40/each) 1&amp;2) P/S Corners at Head of Bed 3&amp;4) P/S D/S Front Dinette Corners</b>
1DEC16 SM	LED Awning Light Strip
1DEC16 SM	Air Conditioner with Digital Thermostat ( <b>11,000 BTU</b> ) Dometic
7DEC16 SM	MaxxFan Upgrade 7500K (with remote) <b>Smoke Grey</b>
1DEC16 SM	Wireless Back - Up Camera <b>Display Monitor wired with 12V Plug</b>
1DEC16 SM	Extra Insulation & Frame-less Thermal Windows ( <b>Includes Opening Rear Window, Frt. Window with Rock Shield Non-Thermal</b> )
1DEC16 SM	Opening Window in Bathroom ( <b>Frame-less Thermal</b> )
1DEC16 SM	Opening Window in Kitchen ( <b>Frame-less Thermal</b> )
1DEC16 SM	Aluminum Rim Package ( <b>Includes 5 Aluminum Rims</b> )
1DEC16 SM	High Lift Axle
1DEC16 SM	Power Tongue Jack
1DEC16 SM	Cabinet Door at end of Bench
1DEC16 SM	<b>3- Shelves in Wardrobe Closet (\$75/each) Evenly Spaced</b>
1DEC16 SM	Exterior Propane Quick Connect with 12' Propane Hose and Adapter
1DEC16 SM	Spray Foam Insulation for Under Trailer
1DEC16 SM	Storage Box (Front of Trailer)



7DEC16 SM	Custom Flooring (12' x 11') Echo Sign Rec'd 7DEC16 SM
	Custom Formica (Additional \$100 for finish other than -58) Denim Twill 8814-58
10NOV16 SM	Trim Color: <b>DARK BROWN</b>
	Custom Fabric (Single Fabric \$100, Additional Fabrics \$50/each) 5m or 5.5yds * Please note fabrics with a repeating pattern will require the amount to be doubled - SOLID - <b>RCV'D 30NOV</b>
30NOV16 JP	<b>CX REQ. ANY SCRAP FABRIC BE SAVED- 06DEC16- JP</b>
1DEC16 SM	Graphic Color: Bright Orange

#### Additional Options:

1DEC16 SM	2 - Filled Propane Tanks (Included with Starter Kit)
1DEC16 SM	Extendable Wall Mount TV Arm (For 15" - 22" TVs)
7DEC16 SM	Fridge Fan
7DEC16 SM	Fridge Storage Bars
7DEC16 SM	Hitch Lock (Included with Starter Kit)
7DEC16 SM	Rhino Sewer Tube Kit
7DEC16 SM	Sand Pads (Set of 4)
7DEC16 SM	X - Chocks
7DEC16 SM	Toilet Chemical (Liquid or Drop in Tablets)
7DEC16 SM	Toilet Paper
7DEC16 SM	Trailer Delivery (Please note this Option will be billed on a Separate Invoice)
7DEC16 SM	Water Filter
7DEC16 SM	Wireless Temperature Guage (For Fridge)

#### Customer Referral:

**Subtotal** (Base Price + Opt

Brokerage Fees (US Customers O

Tire L

Documentation

Customization

**Subtotal A** (Subtotal + Misc. F

(AB, BC, SK, MB, QC, NWT, NU, YT)

(BC)

(NB, NL, ONT)

(PEI)

(NS)

**Total** (Subtotal A + Ta

Rec'd 8JUN16 AMEX AC#863014 KW

**Less Dep**

Payments in Cana

F

Payments in US F

Dealer # 30935

**Balance**

**ALL PRICES LISTED IN CANADIAN FUNDS**

# 19' Escape

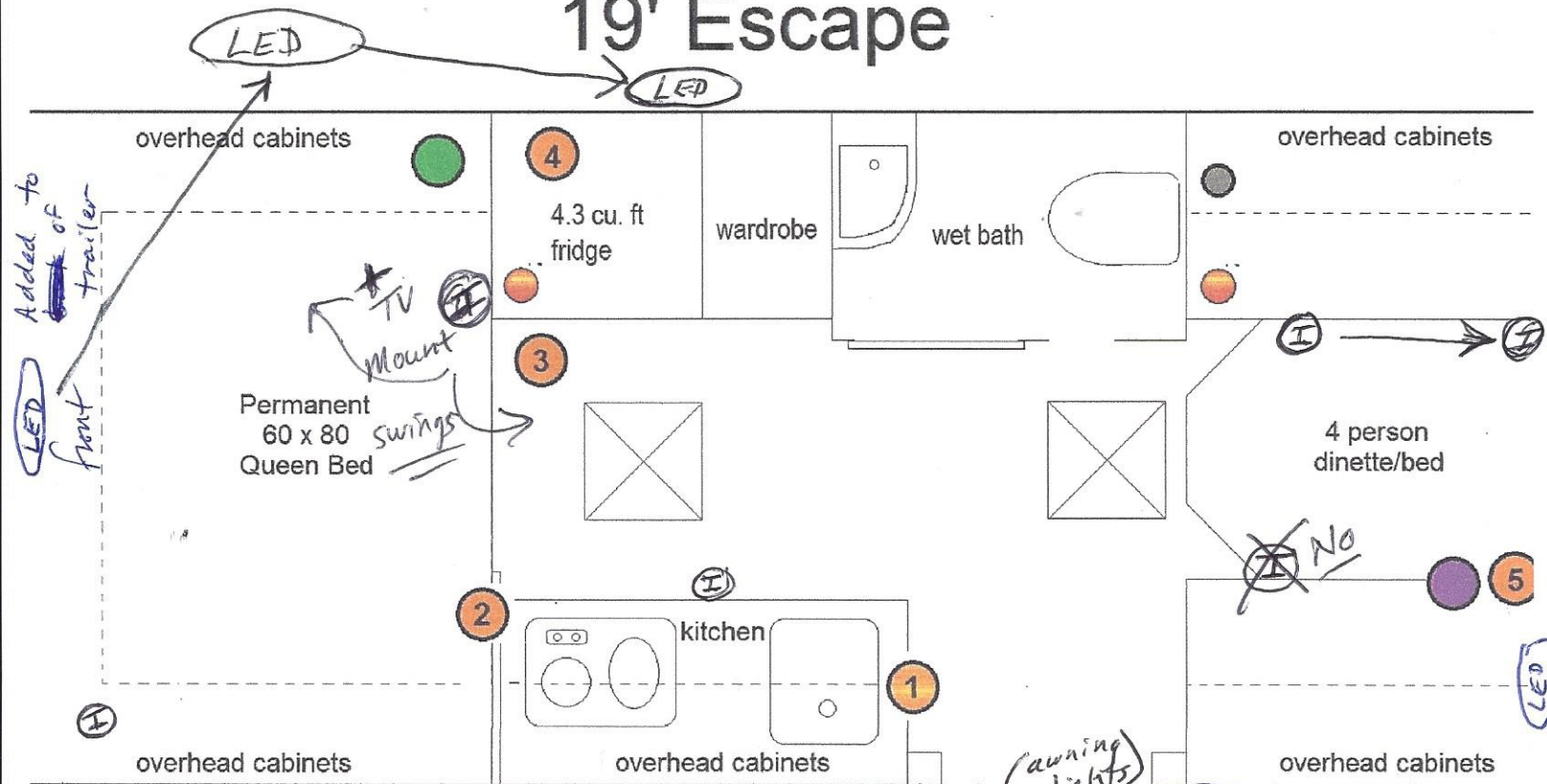

(E) = Standard

No High  
No Low

(awning lights)  
entry

(I) Add Interior Outlet  
(E) Add Exterior Outlet

Standard Location for 12V/USB Outlet Front Dinette. Passenger Side, near 120V Outlet

Standard Location for TV Coaxial with 120V Outlet. Located in face of Overhead Cabinet beside Fridge Wall.

LED = Exterior Lights

1. 120V Outlet in Kitchen Wall, Door Side just below edge of counter.
2. 120V Outlet in Kitchen Wall, Bed Side, just below edge of counter.
3. 120V Outlet in Fridge Wall, Face Wall below fridge.
4. 120V Outlet in Microwave Cabinet above Fridge.
5. 120V Outlet at Front Passenger Side Bench beside 120V.

Per Sarah,

Standard:

1 by door

1 by utilities (driver's side).

Standard Location for TV with Wineguard TV Antenna. Jack Antenna Located center of the trailer toward the front

Standard Location for Solar Panel Monitor. In the face of the overhead cabinet above the fridge or above front driver's side dinette bench. The location will be determined by the fridge size.

So ... I added one to the FRONT of trailer.